

PIN	FUNCTION
1	MOTOR U YELLOW
2	MOTOR V RED
3	MOTOR W BLACK
4	MOTOR PE YELLOW/GREEN

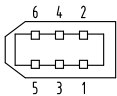

Housing:H66L6-04P
Terminal:T66L6-A

PIN	FUNCTION	COLOR
1	VCC +5V	WHITE
2	GND	BLACK
3	VB	ORANGE
4	GND	BROWN
5	SD	BLUE
6	/SD	PURPLE



SC-06

Connector Detail (Power Wire)

Connector Detail (Feedback Wire)

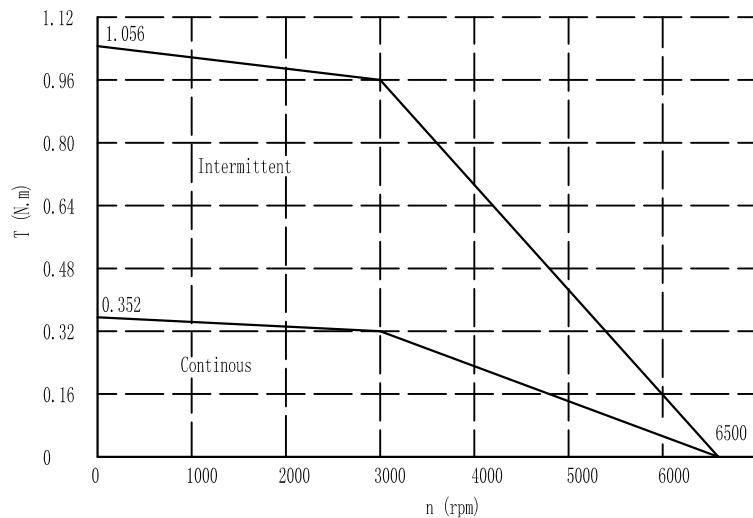
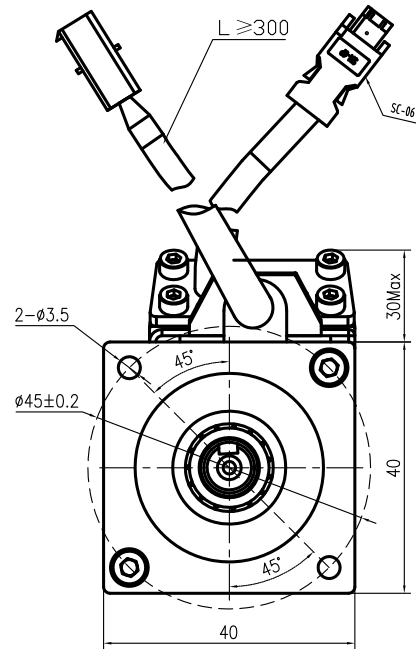
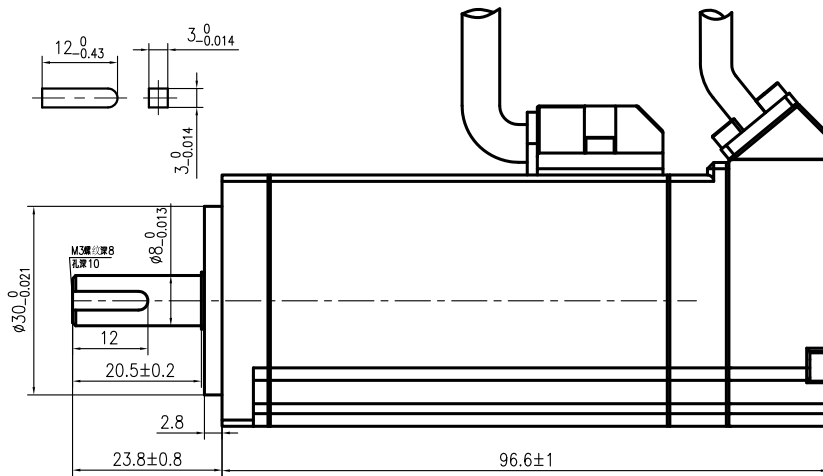

S/N:51NUK00YYDDDDNNNN

Technical Data		
No. of poles	10	
DC Link Voltage U_{dc} (DC Link)	48	
Rated Power P_n (W)	100	
Rated Torque T_n (N.m)	0.32	
Rated Speed n_n (rpm)	3000	
Rated Current I_n (A)	3.2	
Maximum torque T_m (N.m)	0.96	
Maximum Current I_m (A)	9.6	
Standstill torque T_s (N.m)	0.352	
Standstill current I_s (A)	3.52	
Resistance line-line R_L (Ω)	1.5	
Inductance line-line L_L (mH)	1.9	
Electrical time constant τ_e (ms)	1.27	
Mechanical time constant τ_m (ms)	0.67	
Voltage constant K_v (V/krpm)	7	
Torque constant K_t (Nm/A)	0.11	
Rotor moment of inertia J_m (Kg.cm ²)	0.033	
Max. voltage rising du/dt (KV/ μ s)	8	
Insulation class	F	
Max. radial force F_r (N)	120	
Max. axial force F_a (N)	60	
Weight(Kg)	0.57	
Feed back device	MAR-MX50AHN00	
Temperature sensor	n.a.	
Cooling method	Totally enclosed non-ventilated	
protection level	IP64, shaft sealing IP54	
Environmental conditions	Temperature	-20℃ ~40℃
	Humidity	Below 90%RH (No dewing)
	Environment	Far away active gas,combustible gas,oil drop,ash.
	Installation altitude	UP TO 1000m:rated power, above 1000m:15% power decreasing per 100m,max.4000m
Rating conditions	Mounting	Aluminum flange 305x305x13mm
	Temperature	60K housing temperature ring at 40℃ ambient

REV	ECN NO.	DESCRIPTION	DRN	APP'D	DATE	DESIGN	DATE	P/N.	9.5600SS
						ZZB	2019-02-13	TITLE	外形图
UNLESS OTHERWISE SPECIFIED TOLERANCES:						CHECK		USED ON	SMS40S-0010-30KAK-5DSU
DECIMALS: .x ±0.5						YJL	2019-02-13	DWG NO.	
.xx ±0.25						APPD		REV	
.xxx ±0.1						S L	2019-02-13		
UNIT: mm						SCALE			
DO NOT SCALE DRAWING						SHEET	OF		
FIRST ANGLE PROJECTION									KINCO MOTOR